

MCN серия

стандартни цилиндри, ISO 6431

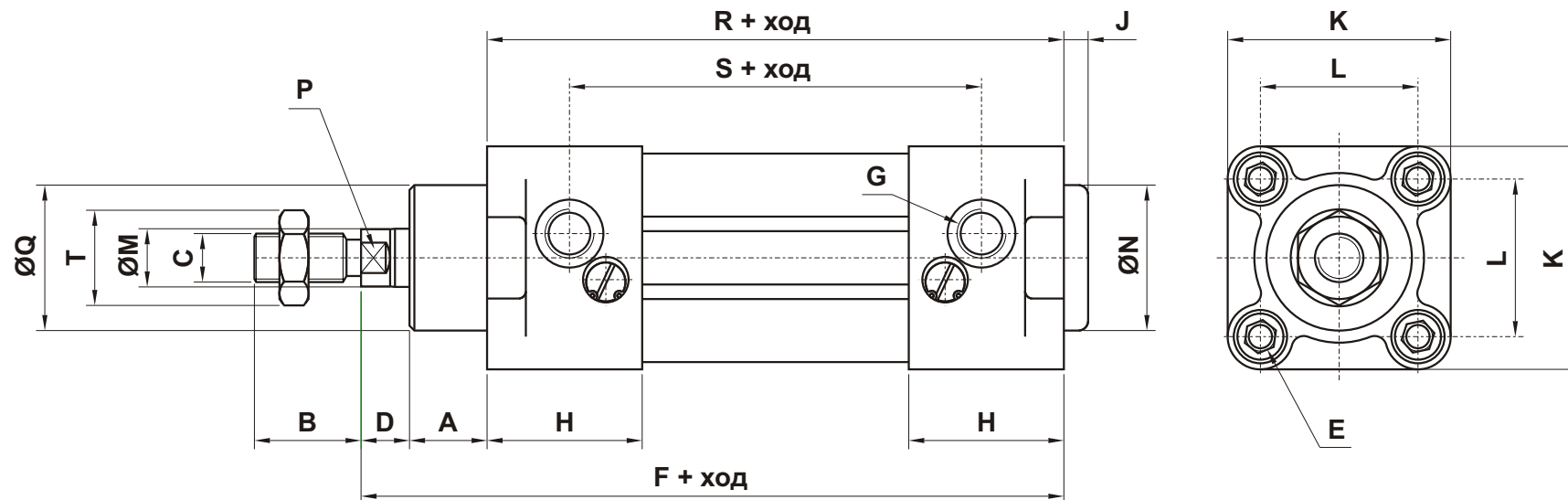

\emptyset	A	B	C	D	E	F	G	H	J	K	L	M	N	P	Q	R	S	T
32	16	22	M10 X 1.25	10	M6	120	G 1/8"	25.5	5	47	32.5	12	30	10	30	94	63.6	17
40	20	24	M12 X 1.25	10	M6	135	G 1/4"	28	5	53	38	16	35	13	35	105	76	19
50	25	32	M16 X 1.5	12	M8	143	G 1/4"	30	5	64	46.5	20	40	17	40	106	69.4	24
63	25	32	M16 X 1.5	12	M8	158	G 3/8"	31	5	74	56.5	20	45	17	45	121	85.2	24
80	32.5	40	M20 X 1.5	14	M10	174	G 3/8"	34	5	94	72	25	45	22	45	128	90	30
100	35	40	M20 X 1.5	16	M10	189	G 1/2"	35	5	112	89	25	55	22	55	138	104	30
125	40	54	M27 X 2	25	M12	225	G 1/2"	41	5	136	110	32	60	27	60	160	112	41